



École J.H. Sissons at École William McDonald School Re-Opening Information for Parents Update #2 – Sunday, August 30, 2020

Introduction

School restarts tomorrow!! On August 19th, I sent you a newsletter outlining our approach to school opening. We are pleased that much of the information contained within it remains the same. However, we now have some additional details regarding home screening for COVID symptoms, the parking procedures, and our process for welcoming students back. Otherwise, the information contained in the August 19th bulletin is unchanged.

I am looking forward to as full a resumption of classes as possible, with the possible expansion of programs and opportunities as those opportunities present themselves.

Graham Arts
Principal

Phones Not Yet Connected

As of this moment, our phones are still not working properly. Therefore, we ask that you continue to send us your emails at jhs@yk1.nt.ca. We hope to have this issue resolved during the day tomorrow and will update you once this has been done.

Parents Accompanying Students in Junior Kindergarten and Kindergarten

Our school's visitor policy has been adapted for the parents of Junior Kindergarten/Kindergarten students. Until further notice, parents of JK/K students may accompany their students to the into the hallway of the portables, and then to the doors of their classrooms. This will help make the transition into the school easier for our youngest students. Unfortunately, our policy for parents of our remaining students is unchanged, and visitors are not permitted at this time.

Contents

INTRODUCTION	1
PARENTS ACCOMPANYING STUDENTS IN JUNIOR KINDERGARTEN AND KINDERGARTEN	1
CONTENTS	1
STUDENT INFORMATION SHEETS.....	2
PARKING, DROP-OFF AND PICK-UP.....	2
COVID-19 SCREENING TOOL FOR FAMILIES	2

École JH Sissons @ William McDonald

50 Taylor Rd, Yellowknife, NT
X1A 3X2

JHS Phone: (867) 873-3477
(not active yet)

WMS Phone: (867) 873-5814
(only for emergencies)

Email: jhs@yk1.nt.ca

Web: jhs.yk1.nt.ca

Facebook:

www.facebook.com/yk1jhs

Student Information Sheets

We want to make sure we can keep your children safe from the moment they arrive on our grounds until the moment you or the bus picks them up. For that reason, many teachers have sent home individual classroom information forms. This helps them to organize their classes at the end of the day and streamline pickups. Soon after this bulletin is sent home, we will follow up with an additional posting in which we will send you this form electronically. We ask that you fill it out and that you email it back to your child's teacher. Returning the .pdf form electronically helps to minimize the transfer of paper to and from homes and helps to keep everyone safe.

Parking, Drop-Off and Pick-Up

I would like to extend my thanks to Mr. Seabrook and his staff for working very hard to get the parking and traffic flow optimized. This work is crucial due to the increased number of students attending this school, and the attendant increases in buses and traffic flow. At the bottom of this bulletin, we have included a diagram that explains the revised traffic flow this year. I would also like to thank Mr. Seabrook for providing us with this helpful description.

We have added a second drop off lane to accommodate this increased traffic and we have designated parking spots for parents/guardians who will need to escort their child/ren to the school (JK/K -2 parents mostly). Please take a close look at the diagram attached to this document so that you are familiar with the process for dropping off.

*There will be only one-way access so it will be very important for you to make sure that you understand the expectations and follow the signage that has been created to make this safe for everyone. You will see that the old drop off area will have designated 15 minute parking areas on the far left. The middle lane is for driving through (NOT to drop off) and the right lane is strictly a "Drop Off" or "Kiss and Ride". The **NEW** drop off will strictly be a " Drop Off" or "Kiss and Ride" on the right and a drive through on the left. All traffic will go through both drop off areas and exit at the far end of the field closest to the firehall. The middle exit will be strictly for BUSES as we cannot allow for two-way traffic in this location.*

Unless you need to use the disability parking area there is no need to come up into the upper parking area. Please use the lower area to park and escort or enter into the building (when guests are permitted into the building by the CPHO). All parents who wish to walk their child up to the entrance of the school or to the portables must park in the designated areas to do so.

Thank you for your cooperation and understanding, we know that there will be some growing pains with this transition for everyone.

COVID-19 Screening Tool for Families

We are including the NWT's screening tool for families and schools. We ask that families review this tool every school day with their children in order to determine if it is appropriate to send them to school. Thank you for your help in keeping everyone safe and healthy.



Commission scolaire francophone
Territoires du Nord-Ouest

TRAFFIC FLOW

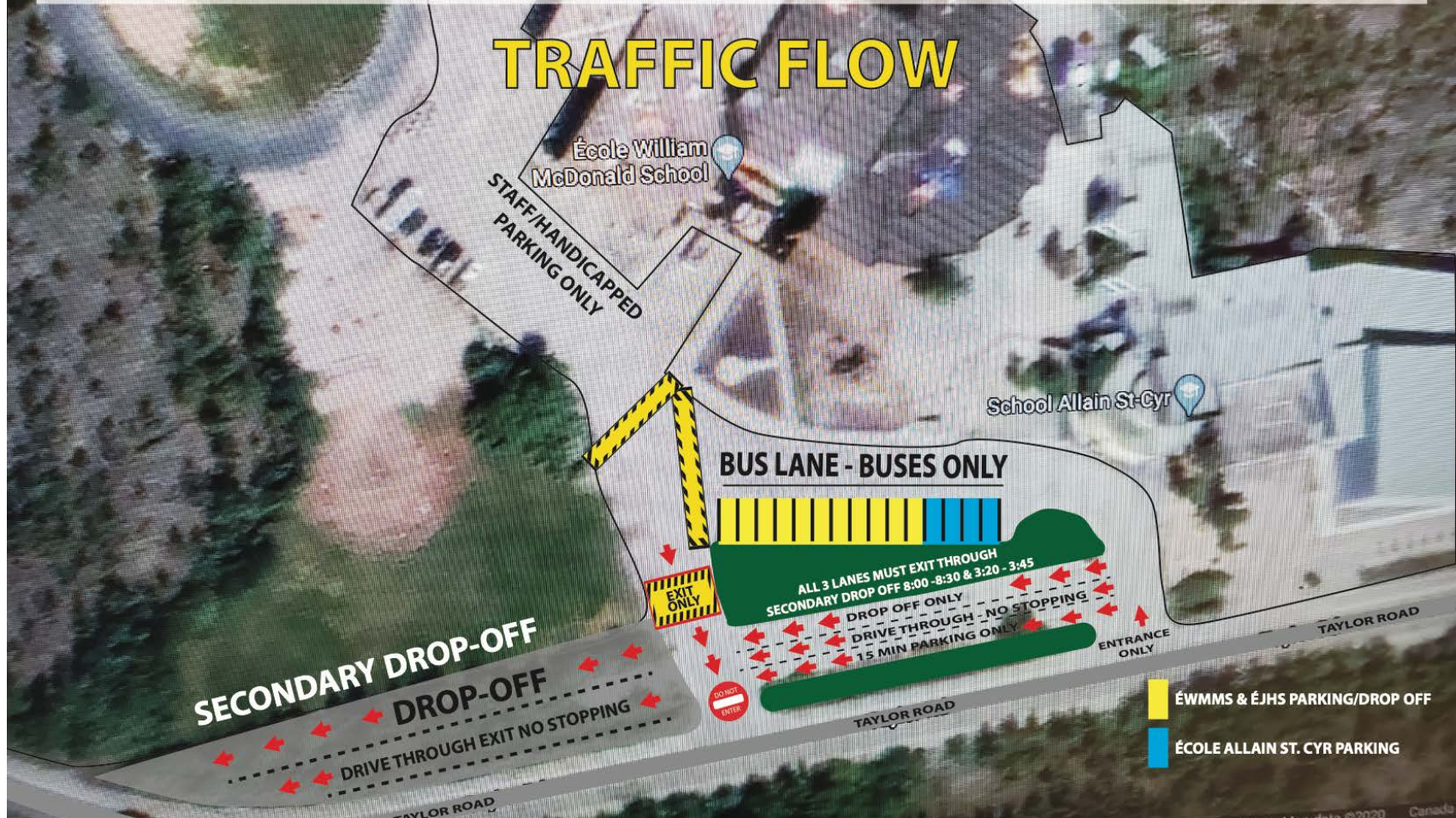



COVID-19 INFORMATION FOR STUDENTS

Daily Symptom Screening Tool

Use this COVID-19 screening tool with your child every morning before going to school.

- 1.** Has your child travelled outside of the NWT, or had close contact with anyone who has travelled outside of the NWT in the past 14 days?
Has your child had close contact with anyone who is showing symptoms of COVID-19, is awaiting a COVID-19 test result, or has tested positive for COVID-19 in the past 14 days?
- If the answer is YES to one or both questions above, please keep your child at home and contact public health for next steps.** If the answer to both questions is NO, move to Step 2.

- 2.** Does your child have **ONE or more** of the following symptoms?



Fever



New or worsening
cough



Shortness of breath

If your child has ONE or more of these symptoms, please keep them at home and contact public health for next steps. If your child has none of these symptoms, move to Step 3.

You can find your local public health phone number here:
<https://www.hss.gov.nt.ca/en/hospitals-and-health-centres>

My local public health/health centre phone number:

- 3.** Does your child have **TWO or more** of the following symptoms?



Sore throat



Runny nose



Nausea/vomiting



Diarrhea



Headache



Feeling generally
run down and tired



New loss or
decrease in sense
of taste or smell



Body aches

If your child has TWO or more of these symptoms, please keep them at home and contact public health for next steps.

Updated: Aug. 26, 2020



INFORMATION POUR ÉLÈVES SUR LA COVID-19

Outil de dépistage quotidien des symptômes de la COVID-19

Veuillez utiliser cet outil de dépistage des
symptômes de la COVID-19 pour votre enfant
tous les matins avant d'aller à l'école.

- 1.** Au cours des 14 derniers jours, votre enfant a-t-il voyagé à l'extérieur des TNO ou eu un contact étroit avec une personne qui a voyagé à l'extérieur des TNO?
Est-ce que votre enfant a eu un contact étroit avec une personne qui présente des symptômes de la COVID-19, qui attend le résultat d'un test de dépistage de la COVID-19 ou qui a reçu un résultat positif à un test de dépistage de la COVID-19 au cours des 14 derniers jours?

Si vous avez répondu OUI à au moins l'une de ces questions, veuillez garder votre enfant à la maison et communiquer avec le service de santé public pour vous informer des prochaines mesures à prendre. Si vous avez répondu NON aux deux questions, passez à la deuxième étape.

- 2.** Est-ce que votre enfant présente **UN ou plusieurs** des symptômes suivants?



Fièvre



Nouvelle toux ou
qui s'aggrave



Difficulté à respirer

Si votre enfant présente UN ou plus de ces symptômes, veuillez garder votre enfant à la maison et communiquer avec le service de santé public pour vous informer des prochaines mesures à prendre. Si votre enfant ne présente aucun de ces symptômes, passez à la troisième étape.

Vous trouverez le numéro de téléphone du Service de santé publique au :

<https://www.hss.gov.nt.ca/fr/hopitaux-et-centres-de-sante>

N° de téléphone du service de santé publique de ma région : _____

- 3.** Est-ce que votre enfant présente **DEUX ou plusieurs** des symptômes suivants?



Mal de gorge



Nez qui coule

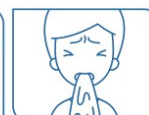

Nausées ou
vomissements



Diarrhée



Mal de tête



Sensation générale
de malaise



Perte ou diminution
récente du goût et
de l'odorat



Douleurs musculaires

Si votre enfant présente DEUX ou plus de ces symptômes, veuillez garder votre enfant à la maison et communiquer avec le service de santé public pour vous informer des prochaines mesures à prendre.

Mise à jour : 26 août 2020